

# studio 1

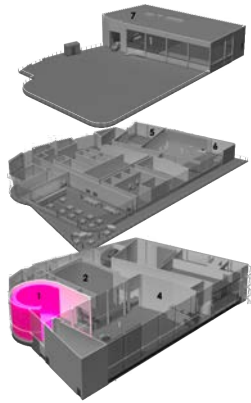

- . 210 m<sup>2</sup>
- . **Round cove** with ceiling returns
- . 13m in diameter (42.7ft)
- . 17m clearance (55.8ft)
- . Useful height : 8m (26.2ft)
- . **Floating ceiling** half circle, motorized
- . Drive-in access truck up to 30m<sup>3</sup> (w3xh3.8m / 9.8x12.5 ft)
- . Water supply
- . Mezzanine for client and make-up
- . Power supply : 125amp - 75kw, three phase Marechal outlets (1 x 125A - 3 x 63A)

