

# studio 2

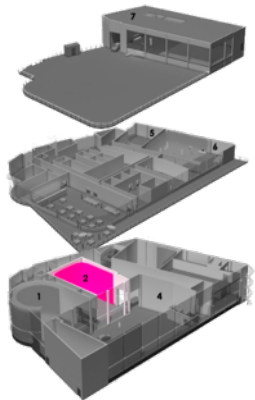

- . 200 m<sup>2</sup>
- . **Three-walled cove**, 12x12m (39.4x39.4ft)
- . 17m clearance (55.8 ft)
- . Useful height : 8m (26.2ft)
- . Lighting rigging possibilities
- . **Floating ceiling** 9x6m, motorized (29.5x19.7ft)
- . Drive-in access truck up to 30m<sup>3</sup> (W2.5xH4.8m / 8.2x15.7ft)
- . Water supply
- . Mezzanine for client and make-up
- . Power supply : 125amp - 75kw,  
three phase Marechal outlets (1 x 125A - 3 x 63A)
- . Rate : 1000€ per day – 700€ for half a day

